



THAI LIN RADIO

since 1975

Фильтр синфазный
герметизированный 440Vac
ENCAPSULATED COMMON
MODE FILTER -



- Inductance range : 0.6 ~ 50mH
- Current range : 0.6 ~ 6.3A
- Dielectric strength : 2000Vrms
- Rated voltage : 440Vac
- Vertical housing : reducing the area of PC board used
- Excellent for switching power supply, DC drive and stepper motor control applications

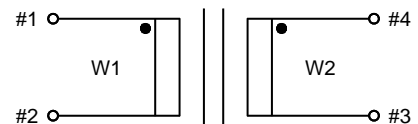
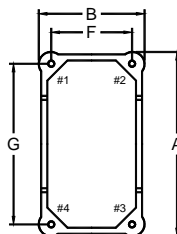
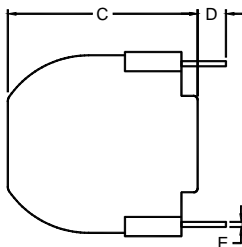

Product Series	Dimension (mm)							Weight (g)
	A	B	C	D	E	F	G	
TL451A	15.0	10.2	13.0	3.5	SQ0.5	7.5	12.5	2.8
TL453A	23.0	13.0	23.5	3.5	SQ0.5	10.0	20.0	9.7
Tolerance	±1.0	±1.0	±1.0	±1.0	±0.1	±0.3	±0.5	approx.

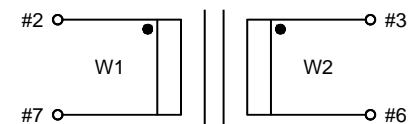
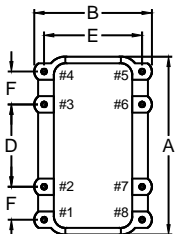
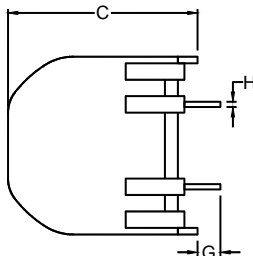

Product Series	Dimension (mm)								Weight (g)
	A	B	C	D	E	F	G	H	
TL24A	32.0	18.0	33.5	12.5	15.0	7.5	3.5	∅0.8	25
Tolerance	±1.0	±1.0	±1.0	±0.5	±0.5	±0.5	±0.5	±0.1	approx.

Note: Unused pins are omitted for standard parts. Unused pins can be provided on request.

Part Number	Inductance (mH)	Current (A)	Part Number	Inductance (mH)	Current (A)
TL451A-006-113	2 x 11	0.6	TL24A-006-503	2 x 50	0.6
TL451A-010-402	2 x 4	1.0	TL24A-010-333	2 x 33	1
TL451A-020-102	2 x 1	2.0	TL24A-014-273	2 x 27	1.4
TL453A-010-203	2 x 20	1	TL24A-020-682	2 x 6.8	2
TL453A-020-602	2 x 6	2	TL24A-040-332	2 x 3.3	4
TL453A-040-152	2 x 1.5	4	TL24A-060-202	2 x 2	6
TL453A-063-601	2 x 0.6	6.3			

Телефон в Москве +7 (499) 500 94 02;
Телефон в Минске +375 (29) 707 79 46;

E-mail: belterratrans@gmail.com -
Веб-сайт: <http://belterratrans.com/> -