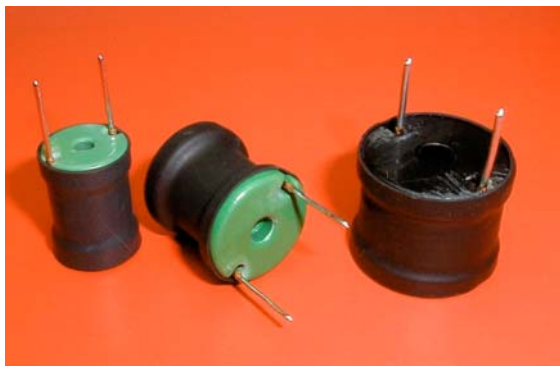

THAI LIN RADIO

since 1975

 Дроссель сетевой (питания)
 POWER LINE CHOKE

TL90 Series

- High saturation materials, ideal for applications requiring both high-current rating and small size
- Used in switching regulators, power supplies, SCR and Triac controls, RFI suppression and filters
- Finished with UL-VW-1 rated sleeve
- With center hole for mechanical mounting
- Custom-made chokes are available upon request

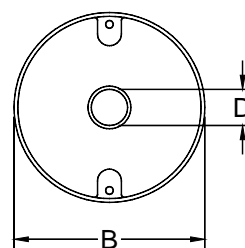
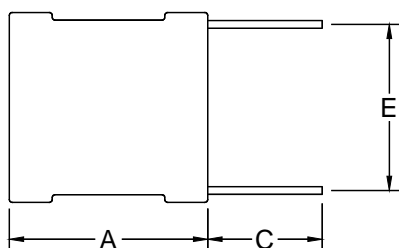

Product Series	Dimension (mm)					Weight (g)
	A	B	C	D	E	
TL90-1	21.5	16.5	12.7	Ø2.8	12.5	13
TL90-2	21.5	21.0	12.7	Ø3.5	15.5	20
TL90-3	21.5	28.0	12.7	Ø4.5	19.5	40
Tolerance	max.	max.	typ.	min.	ref.	approx.

Part Number	Inductance (µH)	Test Frequency	DCR (mΩ, max.)	Rated Current (A DC)	Part Number	Inductance (µH)	Test Frequency	DCR (mΩ, max.)	Rated Current (A DC)
TL90-1-102M	1.0 ± 20%	1 kHz	3	9.0	TL90-1-333K	33 ± 10%	1 kHz	40	4.0
TL90-1-152M	1.5 ± 20%	1 kHz	4	9.0	TL90-1-393K	39 ± 10%	1 kHz	50	4.0
TL90-1-222M	2.2 ± 20%	1 kHz	5	9.0	TL90-1-473K	47 ± 10%	1 kHz	60	2.8
TL90-1-272M	2.7 ± 20%	1 kHz	5	9.0	TL90-1-563K	56 ± 10%	1 kHz	70	2.8
TL90-1-332M	3.3 ± 20%	1 kHz	5	9.0	TL90-1-683K	68 ± 10%	1 kHz	80	2.8
TL90-1-392M	3.9 ± 20%	1 kHz	6	9.0	TL90-1-823K	82 ± 10%	1 kHz	80	2.8
TL90-1-472M	4.7 ± 20%	1 kHz	7	9.0	TL90-1-104K	100 ± 10%	1 kHz	100	2.8
TL90-1-562M	5.6 ± 20%	1 kHz	7	9.0	TL90-1-124K	120 ± 10%	1 kHz	130	2.0
TL90-1-682M	6.8 ± 20%	1 kHz	8	9.0	TL90-1-154K	150 ± 10%	1 kHz	180	1.6
TL90-1-822M	8.2 ± 20%	1 kHz	9	9.0	TL90-1-184K	180 ± 10%	1 kHz	220	1.6
TL90-1-103K	10 ± 10%	1 kHz	10	9.0	TL90-1-224K	220 ± 10%	1 kHz	240	1.6
TL90-1-123K	12 ± 10%	1 kHz	10	9.0	TL90-1-274K	270 ± 10%	1 kHz	300	1.6
TL90-1-153K	15 ± 10%	1 kHz	20	7.2	TL90-1-334K	330 ± 10%	1 kHz	340	1.3
TL90-1-183K	18 ± 10%	1 kHz	20	7.2	TL90-1-394K	390 ± 10%	1 kHz	460	1.0
TL90-1-223K	22 ± 10%	1 kHz	30	5.5	TL90-1-474K	470 ± 10%	1 kHz	640	0.8
TL90-1-273K	27 ± 10%	1 kHz	30	4.5	TL90-1-564K	560 ± 10%	1 kHz	700	0.8



THAI LIN RADIO

since 1975

POWER LINE
CHOKE

Part Number	Inductance (μH)	Test Frequency	DCR (mΩ, max.)	Rated Current (A DC)	Part Number	Inductance (μH)	Test Frequency	DCR (mΩ, max.)	Rated Current (A DC)
TL90-2-102M	1.0 ± 20%	1 kHz	3	11	TL90-3-152M	1.5 ± 20%	1 kHz	3	21
TL90-2-222M	2.2 ± 20%	1 kHz	4	11	TL90-3-222M	2.2 ± 20%	1 kHz	3	21
TL90-2-332M	3.3 ± 20%	1 kHz	5	11	TL90-3-332M	3.3 ± 20%	1 kHz	3	21
TL90-2-392M	3.9 ± 20%	1 kHz	5	11	TL90-3-472M	4.7 ± 20%	1 kHz	3	21
TL90-2-472M	4.7 ± 20%	1 kHz	5	11	TL90-3-682M	6.8 ± 20%	1 kHz	4	21
TL90-2-562M	5.6 ± 20%	1 kHz	6	11	TL90-3-822M	8.2 ± 20%	1 kHz	4	21
TL90-2-682M	6.8 ± 20%	1 kHz	7	11	TL90-3-103M	10 ± 20%	1 kHz	6	17
TL90-2-822M	8.2 ± 20%	1 kHz	7	11	TL90-3-123M	12 ± 20%	1 kHz	8	13
TL90-2-103M	10 ± 20%	1 kHz	9	11	TL90-3-153K	15 ± 10%	1 kHz	9	13
TL90-2-123K	12 ± 10%	1 kHz	9	11	TL90-3-183K	18 ± 10%	1 kHz	10	13
TL90-2-153K	15 ± 10%	1 kHz	10	9.0	TL90-3-223K	22 ± 10%	1 kHz	10	13
TL90-2-183K	18 ± 10%	1 kHz	20	7.2	TL90-3-273K	27 ± 10%	1 kHz	10	13
TL90-2-223K	22 ± 10%	1 kHz	20	7.2	TL90-3-333K	33 ± 10%	1 kHz	20	13
TL90-2-273K	27 ± 10%	1 kHz	30	5.5	TL90-3-393K	39 ± 10%	1 kHz	20	11
TL90-2-333K	33 ± 10%	1 kHz	30	5.5	TL90-3-473K	47 ± 10%	1 kHz	20	9.0
TL90-2-393K	39 ± 10%	1 kHz	30	5.5	TL90-3-563K	56 ± 10%	1 kHz	30	9.0
TL90-2-473K	47 ± 10%	1 kHz	40	5.5	TL90-3-683K	68 ± 10%	1 kHz	30	9.0
TL90-2-563K	56 ± 10%	1 kHz	40	5.5	TL90-3-823K	82 ± 10%	1 kHz	30	9.0
TL90-2-683K	68 ± 10%	1 kHz	50	4.8	TL90-3-104K	100 ± 10%	1 kHz	30	9.0
TL90-2-823K	82 ± 10%	1 kHz	60	4.8	TL90-3-124K	120 ± 10%	1 kHz	50	7.2
TL90-2-104K	100 ± 10%	1 kHz	80	4.0	TL90-3-154K	150 ± 10%	1 kHz	60	5.5
TL90-2-124K	120 ± 10%	1 kHz	90	4.0	TL90-3-184K	180 ± 10%	1 kHz	70	5.5
TL90-2-154K	150 ± 10%	1 kHz	100	4.0	TL90-3-224K	220 ± 10%	1 kHz	80	5.5
TL90-2-184K	180 ± 10%	1 kHz	110	4.0	TL90-3-274K	270 ± 10%	1 kHz	110	4.5
TL90-2-224K	220 ± 10%	1 kHz	150	2.8	TL90-3-334K	330 ± 10%	1 kHz	120	4.5
TL90-2-274K	270 ± 10%	1 kHz	210	2.0	TL90-3-394K	390 ± 10%	1 kHz	170	4.0
TL90-2-334K	330 ± 10%	1 kHz	310	1.6	TL90-3-474K	470 ± 10%	1 kHz	190	4.0
TL90-2-394K	390 ± 10%	1 kHz	320	1.6	TL90-3-564K	560 ± 10%	1 kHz	210	4.0
TL90-2-474K	470 ± 10%	1 kHz	360	1.6	TL90-3-684K	680 ± 10%	1 kHz	260	2.8
TL90-2-564K	560 ± 10%	1 kHz	390	1.6	TL90-3-824K	820 ± 10%	1 kHz	290	2.8
TL90-2-684K	680 ± 10%	1 kHz	430	1.6	TL90-3-105K	1000 ± 10%	1 kHz	430	2.0
TL90-2-824K	820 ± 10%	1 kHz	590	1.3	TL90-3-125K	1200 ± 10%	1 kHz	460	2.0
TL90-2-105K	1000 ± 10%	1 kHz	820	1.0	TL90-3-155K	1500 ± 10%	1 kHz	520	2.0
TL90-2-125K	1200 ± 10%	1 kHz	1100	0.8	TL90-3-185K	1800 ± 10%	1 kHz	710	1.6
TL90-2-155K	1500 ± 10%	1 kHz	1300	0.8	TL90-3-225K	2200 ± 10%	1 kHz	1000	1.3
TL90-2-185K	1800 ± 10%	1 kHz	1400	0.8	TL90-3-275K	2700 ± 10%	1 kHz	1100	1.3
TL90-2-225K	2200 ± 10%	1 kHz	1500	0.8	TL90-3-335K	3300 ± 10%	1 kHz	1300	1.3
					TL90-3-395K	3900 ± 10%	1 kHz	1700	1.0
					TL90-3-475K	4700 ± 10%	1 kHz	1900	1.0

Part number suffix : M - represents the Inductance Tolerance of ± 20%

K - represents the Inductance Tolerance of ± 10%